



THE RITZ-CARLTON

SHANGHAI, PUDONG



The Ritz-Carlton Shanghai, Pudong is situated in Pudong's new social and commercial hub, Shanghai IFC, with views over the Bund. It is

Shanghai's ultimate destination for uncompromising style and luxury.



UNIQUE SELLING POINTS

- Centrally located in the heart of Shanghai’s financial district, Lujiazui Financial and Trade Zone, with Pudong’s premier lifestyle destination—IFC—offering numerous top-tier global retailers and a variety of dining and entertainment.
- Offers a panoramic 270-degree view of Pudong, Shanghai’s landscape
- Contemporary Art Deco design
- Spacious rooms with entry-level room type starting at 50 square meters
- The Ritz-Carlton Spa Shanghai, Pudong offers luxurious spa services in 10 beautifully appointed treatment rooms with breathtaking views of the Bund and Huangpu River
- From local to global, enjoy a culinary experience from our Black Pearl and Michelin-starred Jin Xuan Chinese restaurant to the authentic Italian food at “Scena di Angelo.” Sip a cocktail at the unique rooftop bar, Flair, with interior space or terrace seats on the 58th floor
- Relish the natural sunshine from floor-to-ceiling windows. The hotel offers seven multi-purpose function rooms and the largest Grand Ballroom with 1,135 square meters/12,200 square feet, which can be divided into three separate spaces as required to fulfill different event needs
- Function rooms range in size and can be adapted for a variety of purposes with convenient car access from outside

OUR LOCATION

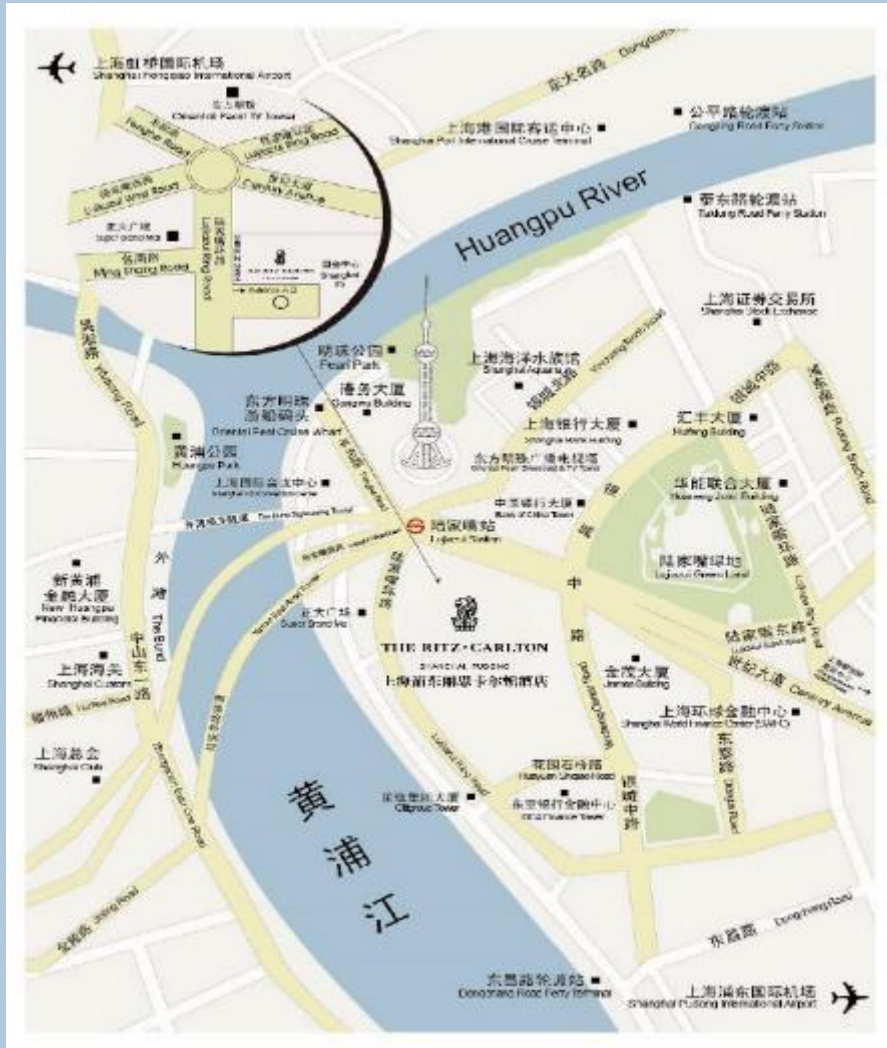

Located with superior access to tourist destinations and conference areas.

- Oriental Pearl Tower (within walking distance)
- Shanghai Disney Resort (27 km by car)
- The Bund (5 km)
- Shanghai New International Expo Center (9.5 km)
- Shanghai International Convention Center (within walking distance)

Convenient accessibility by subway Metro Line 2

- To Shanghai Railway (40 mins)
- To Pudong Airport (90 mins)
- To Hongqiao Airport (60 mins)
- To Longyang Road Maglev Station (30 mins)

PREMIER LOCATION



Our hotel is located in the same complex of Shanghai International Finance Centre (Shanghai IFC), which is in the heart of the Lujiazui financial and trade zone. IFC houses over 250 top-tier international retailers and global flagship stores, a stunning selection of international restaurants and various entertainment elements. It gives travelers easier access in walking distance to restaurants, shops and other relaxation facilities while staying at the hotel.

THE RITZ-CARLTON

Located on the upper levels of IFC, an ultra-modern 58-story skyscraper, the hotel not only offers stunning views of the Bund and the city from the top but also provides a luxurious space for business, retail and accommodation. Such a modern and nostalgic atmosphere of Shanghai city has contributed to the contemporary design of the hotel by famous Singapore designer, Richard Farnell.

With the prominent location, it is convenient to get to and from the hotel to and from different locations, such as Hongqiao Airport (25 km), PVG (40 km) and Maglev Station at Longyang Road (12 km).

THE RITZ-CARLTON



HOTEL MAIN ENTRANCE



HOTEL LOBBY



A row of several wine glasses is arranged on a table. In the foreground, a white napkin is folded. The background is a blurred view through a window, showing a cityscape under a blue sky. The overall color palette is dominated by light blues and whites.

GUEST ROOMS

GUEST ROOMS (39th– 51st FLOOR)



The Ritz-Carlton Shanghai, Pudong captures the essence of the city with tastefully extravagant accommodations that overlook the Shanghai skyline. Sophisticated comfort awaits in 285 luxury hotel rooms and suites that have been masterfully designed with modern amenities and Art Deco accents.

THE RITZ-CARLTON

DELUXE ROOM
(1 KING BED, CITY VIEW, GUEST ROOM)



CITY LIGHTS VIEW
(1 KING BED, SKYLINE VIEW, GUEST ROOM)



CITY LIGHTS VIEW TWIN
(2 DOUBLE BEDS, SKYLINE VIEW, GUEST ROOM)



STUDIO
(1 KING BED, SKYLINE VIEW, LARGE ROOM)



PEARL TOWER VIEW ROOM
(1 KING BED, PEARL TOWER VIEW, GUEST ROOM)



SHANGHAI BUND VIEW TWIN
(2 DOUBLE BEDS, THE BUND RIVER VIEW, GUEST ROOM)



SHANGHAI BUND VIEW ROOM (1 KING BED, THE BUND RIVER VIEW, GUEST ROOM)



SHANGHAI BUND VIEW SUITE (1 KING BED, THE BUND RIVER VIEW, SUITE)



CLUB PANORAMIC SUITE

(1 KING BED, SKYLINE VIEW, CLUB LOUNGE ACCESS, PANORAMIC SUITE)



PEARL TOWER VIEW SUITE
(1 KING BED, PEARL TOWER VIEW, CLUB LOUNGE ACCESS, SUITE)



CARLTON SUITE

(1 KING BED, PEARL TOWER VIEW, CLUB LOUNGE ACCESS, CARLTON SUITE)



CARLTON SUITE

(1 KING BED, PEARL TOWER VIEW, CLUB LOUNGE ACCESS, CARLTON SUITE)



CARLTON SUITE

(1 KING BED, PEARL TOWER VIEW, CLUB LOUNGE ACCESS, CARLTON SUITE)



PREMIER BUND VIEW SUITE

(1 KING BED, THE BUND RIVER VIEW, CLUB LOUNGE ACCESS, LARGE SUITE)



PREMIER BUND VIEW SUITE

(1 KING BED, THE BUND RIVER VIEW, CLUB LOUNGE ACCESS, LARGE SUITE)



CHAIRMAN SUITE

(1 KING BED, THE BUND RIVER VIEW, CLUB LOUNGE ACCESS, CHAIRMAN SUITE)



CHAIRMAN SUITE

(1 KING BED, THE BUND RIVER VIEW, CLUB LOUNGE ACCESS, CHAIRMAN SUITE)



CHAIRMAN SUITE

(1 KING BED, THE BUND RIVER VIEW, CLUB LOUNGE ACCESS, CHAIRMAN SUITE)



THE RITZ-CARLTON SUITE

(1 KING BED, THE BUND RIVER VIEW, CLUB LOUNGE ACCESS, THE RITZ-CARLTON SUITE)



THE RITZ-CARLTON SUITE

(1 KING BED, THE BUND RIVER VIEW, CLUB LOUNGE ACCESS, THE RITZ-CARLTON SUITE)



THE RITZ-CARLTON SUITE

(1 KING BED, THE BUND RIVER VIEW, CLUB LOUNGE ACCESS, THE RITZ-CARLTON SUITE)



THE RITZ-CARLTON SUITE

(1 KING BED, THE BUND RIVER VIEW, CLUB LOUNGE ACCESS, THE RITZ-CARLTON SUITE)



ROOM SIZE

Deluxe Room	50 sq. m.
City Lights View Room	50 sq. m.
Studio	64 – 66 sq. m.
Pearl Tower View Room	48 – 62 sq. m.
Shanghai Bund View Room	50 – 56 sq. m.
Club Deluxe Room	48 – 52 sq. m.
Club Studio	64 sq. m.
Club Bund View Room	50 – 56 sq. m.
Shanghai Bund View Suite	65 – 90 sq. m.
Club Panoramic Suite	90 – 110 sq. m.
Pearl Tower View Suite	74 sq. m.
Premier Bund View Suite	88 – 100 sq. m.
Carlton Suite	105 sq. m.
Chairman Suite	410 sq. m.
The Ritz-Carlton Suite	410 sq. m.

THE RITZ-CARLTON CLUB(49F)



THE RITZ-CARLTON CLUB(49F)

The Ritz-Carlton Club Level, located on 49th-51st floor of the hotel offers guests a private haven with a personalized concierge service for that added touch of comfort and care. The 24-hour Club Level serves five complimentary food and beverage presentations daily.

Club and Suite guests' privilege highlights:

- Enjoy a 2-hour use of a meeting room at the Club Lounge per stay; It is subject to availability.
- Enjoy pressing service of 5 pieces; This service is per room, per day, upon request. (It is non-cumulative).
- Enjoy limousine drop off services for short distance rides within a three kilometer range from 10 a.m. to 7 p.m. with a minimum two hours booking in advance (subject to availability).
- Private check-in and check-out at The Ritz-Carlton Club Lounge.

FIVE CULINARY AND BEVERAGE PRESENTATIONS

▪ Breakfast	06:30-11:00
▪ Mid-day Snacks	11:30-14:00
▪ Afternoon Tea	14:30-17:00
▪ Hors d'oeuvres	17:30-20:00
▪ Evening Snacks	20:30-23:00

WEEKLY FEATURED DINING EXPERIENCE

▪ Handmade Chinese Noodles Experience	Every Wednesday	18:00-19:00
▪ Caviar Degustation	Every Friday	18:00-19:00

THE RITZ-CARLTON CLUB(49F)



SKY LOBBY(52F)



GIFT SHOP (52F)



THE RITZ-CARLTON SPA(55F)



SAUNA(53F&55F)



FITNESS STUDIO(53F)



SWIMMING POOL(53F)



SWIMMING POOL(53F)



THE RITZ-CARLTON SPA(55F)

The Ritz-Carlton Spa is located on the hotel's 55th floor and features:

- 10 treatment rooms in total
- 9 multi-function treatment rooms
- One Harmony Suite

Whether you arrive for the day or a single treatment, this luxury spa offers the promise of renewal with personalized massage and beauty and wellness treatments complemented by views over the breadth of the city. Achieve mind-body balance within this stunning sanctuary, which includes a 24-hour fitness studio, dry sauna, steam room and heated indoor swimming pool.

THE RITZ-CARLTON SPA(55F)



A row of wine glasses is set on a table with a white napkin. The background is a soft, blue-tinted view of a window. The text "CONFERENCE & BANQUETING" is overlaid in white, serif font on the left side of the image.

**CONFERENCE &
BANQUETING**

CONFERENCE FACILITIES



Ample natural light illuminates over 2,600 sq. m. (27,300 sq. ft.) of meeting and conference space conveniently located on the 3rd floor with direct access to Shanghai IFC. The Business Center provides an exclusive conference-concierge and meeting services. The 1,135 sq. m. (12,200 sq. ft.) ballroom is divisible into three salons. Four multi-purpose meeting rooms and two boardrooms are equipped with state-of-the-art facilities and can be adapted to meet a wide range of meeting and catering requirements.

WEDDINGS



Illuminate the dream of a blissful wedding at 7.4-meter high-ceiling Grand Ballroom. Couples can celebrate their biggest day at this serene venue nestled beside a delicate Bridal and Groom VIP room. Dedicated wedding specialists are on the scene to collaborate with bride and groom on all aspects of their most memorable day. From menus, linens, flowers, venue deco, to photos, videos, make up, invitation designs, ceremony planning as well as wedding dress, a one-stop-shop wedding solution for bride and groom crowning the day with luxury.

THE RITZ-CARLTON

SOCIAL GATHERINGS & SPECIAL OCCASIONS



The Ritz-Carlton's Culinary and Catering teams are dedicated to offering seamless service and creativity in organizing tailor-made themed events, team-building activities, and off-site catering for our guests. Hospitality suites and a rooftop bar offer alternative venues for memorable experiences.



CONFERENCE FUNCTION SPACE FLOOR PLAN (3F)

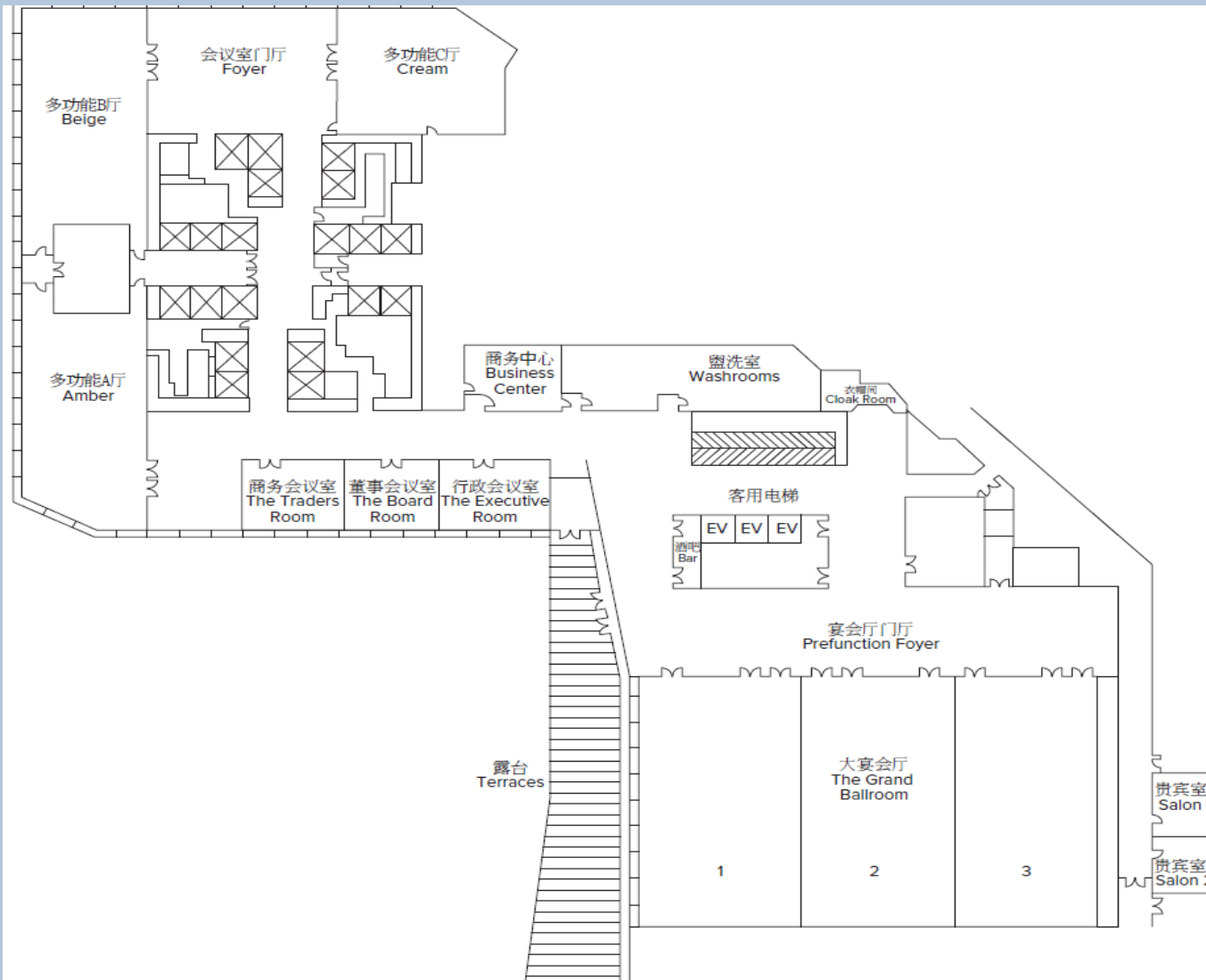

The hotel offers seven multi-purpose function rooms, the largest of which, the 1,135-square-meter/12,200-square-foot Grand Ballroom, can be subdivided into three separate spaces as required. The function rooms range in size and can be adapted for a variety of purposes, but all enjoy access to first-class services and facilities, including wired and wireless Internet access, teleconferencing facilities, the latest audiovisual equipment, technical support, a Technology Butler service and a Business Center.

CONFERENCE SPACE & CAPACITY CHART

Meeting Space	Area		Dimensions		Ceiling Height		Banquet Rounds (10pax)	Theater	Reception	Classroom	U-Shape	Hollow Square
	Square Feet	Square Meters	Feet	Meters	Feet	Meters						
The Grand Ballroom	12,200	1,135	138 x 89	42 x 27	24.27	7.4	700	1188	1200	648	111	156
Ballroom 1	4,357.16	405	50 x 89	15 x 27	24.27	7.4	270	400	400	252	78	90
Ballroom 2	3,921.43	365	45 x 89	14 x 27	24.27	7.4	240	360	360	216	75	84
Ballroom 3	3,921.43	365	45 x 89	14 x 27	24.27	7.4	240	360	360	216	75	84
Ballroom 1+2	8,278.58	770	95 x 89	29 x 27	24.27	7.4	540	740	750	468	99	132
Ballroom 2+3	7,842.87	730	90 x 89	28 x 27	24.27	7.4	480	720	720	432	90	126
Ballroom Foyer	4,357.15	405	148 x 30	45 x 9	15.41	4.7	---	---	430	---	---	---
Amber	2,461.37	230	72 x 34	22 x 11	15.41	4.7	120	220	240	120	57	66
Beige	2,130.16	198	59 x 36	18 x 11	15.41	4.7	120	210	208	120	57	66
Cream	1,822.56	170	44 x 41	14 x 12	15.41	4.7	80	170	180	72	30	42
Meeting Room Foyer	1,703.89	158	40 x 43	12 x 13	15.41	4.7	---	---	170	---	---	---
Board Room	694.67	65	30 x 23	9 x 7	15.41	4.7	董事会议形式容纳12人 Seats 12 persons boardroom style meeting					
Traders Room	694.67	65	30 x 23	9 x 7	15.41	4.7	24	40	60	24	24	30
The Executive Room	979.5	91	43 x 23	13 x 7	15.41	4.7	40	90	60	42	30	34

DINING OPTIONS

A row of several wine glasses is arranged on a table. In the foreground, a white napkin is folded. The background is a blurred blue-tinted scene, possibly a window view. The text 'DINING OPTIONS' is overlaid on the left side of the image.

SCENA DI ANGELO ITALIAN RESTAURANT(52F)



The Italian restaurant on the 52nd floor has invited the awarded Italian Chef Aglianó to revamp the restaurant as SCENA DI ANGELO, inviting you to experience a taste of Mediterranean while enjoying a breathtaking view of the Bund. The main dining area can seating up to 128 guests. The restaurant also offers a private dining space to meet your multiple dining and entertaining needs.

SCENA DI ANGELO ITALIAN RESTAURANT(52F)



SCENA DI ANGELO ITALIAN RESTAURANT(52F)



SCENA DI ANGELO ITALIAN RESTAURANT(52F) CHEF & RESTAURANT VIBE



AURA LOUNGE & JAZZ BAR(52F)



Aura is an ideal venue for enjoying a relaxing get-together with friends or meeting business acquaintances over light meals and drinks. Dimly lit with awe-inspiring views over the Shanghai skyline, in the evening the mood is more romantic as live Jazz is played and guests can experience more than 30 varieties of Rose Champagne and a fine selection of malt whiskies.

Location: Hotel 52nd floor

Total seating: 105 seats

AURA LOUNGE & JAZZ BAR(52F)



JIN XUAN CHINESE RESTAURANT(53F)



Jin Xuan Chinese Restaurant tempts guests with authentic, creative Cantonese cuisine and regional favorites in China. The Michelin and Black Pearl awarded restaurant is ideal for both of social and business gatherings. Jin Xuan was designed by the renowned interior designer and architect from Hong Kong, Steven Leung.

Total seating: Main dining area of 52 seats 6 private dining rooms of 52 seats ; 1 VIP private dining room of 20 seats.

JIN XUAN CHINESE RESTAURANT(53F)



JIN XUAN CHINESE RESTAURANT(53F)



REBORN FROM MEMORIES

As Shanghai's highest iconic rooftop venue on the 58th floor, FLAIR is located right in the center of Lujiazui. With a spectacular view of the Oriental Pearl Tower, FLAIR is the perfect spot for viewing the stunning scenery of the city skyline, the entirety of the Huangpu River and The Bund, as well as offering breathtaking sunset views, presenting a unique experience in the heart of the city.

Location: Hotel 58th floor

Total seating:

- Winter Garden: 50 seats
- Terrace: 45 seats
- Lounge: 80 seats
- Whole Flair: 190 seats



FLAIR ROOFTOP RESTAURANT & BAR(58F)



FLAIR ROOFTOP RESTAURANT & BAR(58F)



FLAIR ROOFTOP RESTAURANT & BAR(58F)



FLAIR ROOFTOP RESTAURANT & BAR(58F)



FLAIR ROOFTOP RESTAURANT & BAR(58F)



FLAIR ROOFTOP RESTAURANT & BAR(58F)



FLAIR ROOFTOP RESTAURANT & BAR(58F)



FLAIR ROOFTOP RESTAURANT & BAR(58F)



FLAIR ROOFTOP RESTAURANT & BAR(58F)



FLAIR ROOFTOP RESTAURANT & BAR(58F)



FLAIR ROOFTOP RESTAURANT & BAR(58F)



FLAIR ROOFTOP RESTAURANT & BAR(58F)



CONTACTS

Joy Deng

Director of Sales and Marketing

Email: joy.deng@ritzcarlton.com

Telephone: (86 21) 2020 1888

Fax: (86 21) 2020 1119

LET
US
STAY
WITH
YOU



THE RITZ-CARLTON